

## Performance Curve

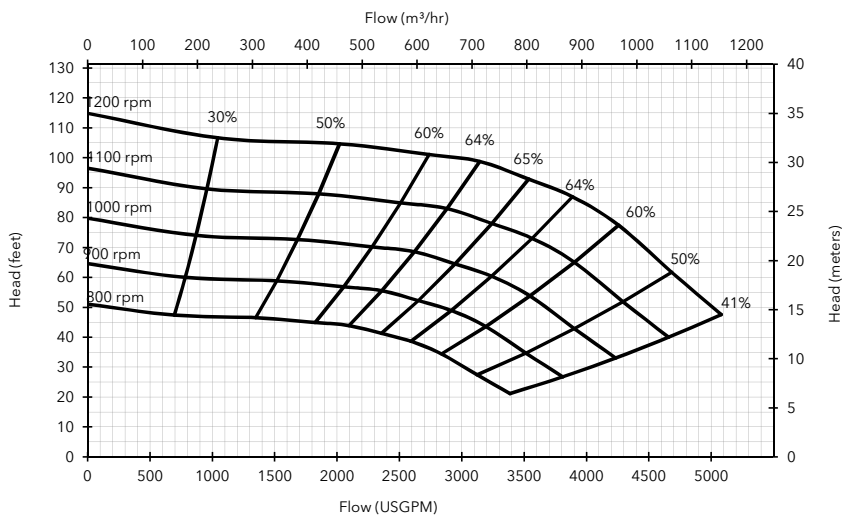

### Engine option 1

John Deere 6068HF285 (T3 Flex), 156 HP @ 2400 rpm

Impeller diameter 16.9"

Pump speed 1200 rpm driven by 2.0:1 gearbox

#### Suction Lift Table

Total Suction Head (feet)	Total Delivery Head (feet)				
	31	45	58	72	86
10	5024	4714	4377	3937	3108
15	4921	4558	4144	3522	1036
20	4403	3885	3108	2072	777
25	2331	2072	1554	1036	-

Fuel capacity: 150 US Gal

Max Fuel consumption @ 2400 rpm: 8.7 US Gal/hr

Max Fuel consumption @ 2000 rpm: 8.0 US Gal/hr

Weight (Dry): 6,250 lbs

Weight (Wet): 7,330 lbs

Dim.: (L) 156" x (W) 55" x (H) 81"

Performance data provided in tables is based on water tests at sea level and 20°C ambient. All information is approximate and for general guidance only. Please contact the factory or office for further details.

## Materials

Pump casing & suction cover	Cast iron BS EN 1561 - 1997
Wearplates	Cast iron BS EN 1561 - 1997
Pump Shaft	Carbon steel BS 970 - 1991 817M40T
Impeller	Cast iron BS EN 1561 - 1997
Non-return valve body	Cast iron BS EN 1561 - 1997
Mechanical seal	Silicon carbide face; Viton elastomers; Stainless steel body

### Engine option 2

John Deere 6068HC93 (IT4), 157 HP @ 2400 rpm

Impeller diameter 16.9"

Pump speed 1200 rpm driven by 2.0:1 gearbox

#### Suction Lift Table

Total Suction Head (feet)	Total Delivery Head (feet)				
	31	45	58	72	86
10	5024	4714	4377	3937	3108
15	4921	4558	4144	3522	1036
20	4403	3885	3108	2072	777
25	2331	2072	1554	1036	-

Fuel capacity: 150 US Gal

Max Fuel consumption @ 2400 rpm: 8.6 US Gal/hr

Max Fuel consumption @ 2000 rpm: 7.9 US Gal/hr

Weight (Dry): 6,550 lbs

Weight (Wet): 7,630 lbs

Dim.: (L) 156" x (W) 55" x (H) 81"

Performance data provided in tables is based on water tests at sea level and 20°C ambient. All information is approximate and for general guidance only. Please contact the factory or office for further details.

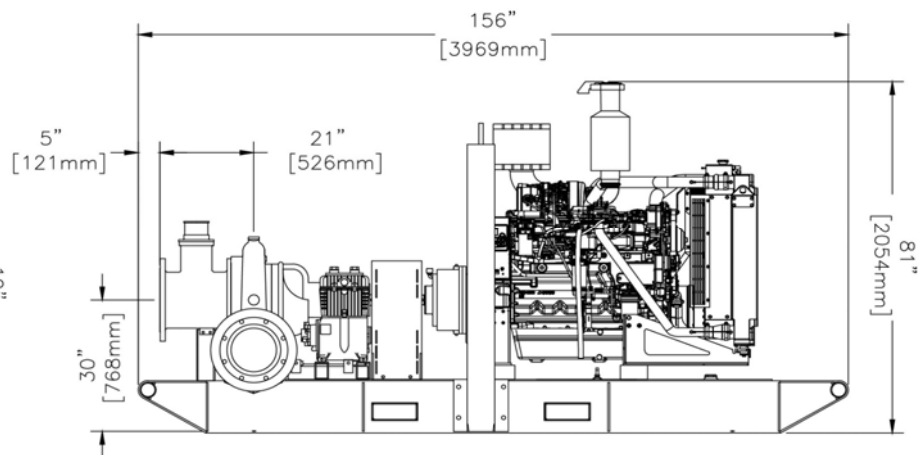
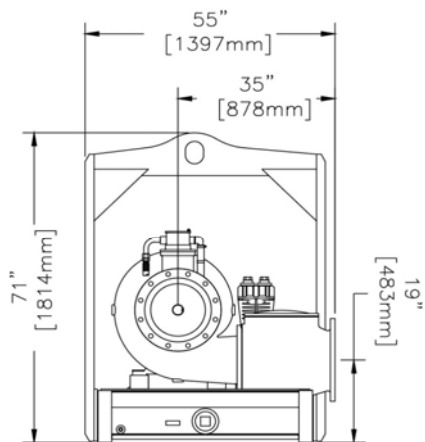

84 Floodgate Road  
Bridgeport, NJ 08014 USA  
(856) 467-3636 . Fax (856) 467-4841  
Email: sales@godwinpumps.com

Reference number : 95-1017-3000  
Date of issue : February 26, 2014  
Issue : 5

[www.godwinpumps.com](http://www.godwinpumps.com)