

## Performance Curve

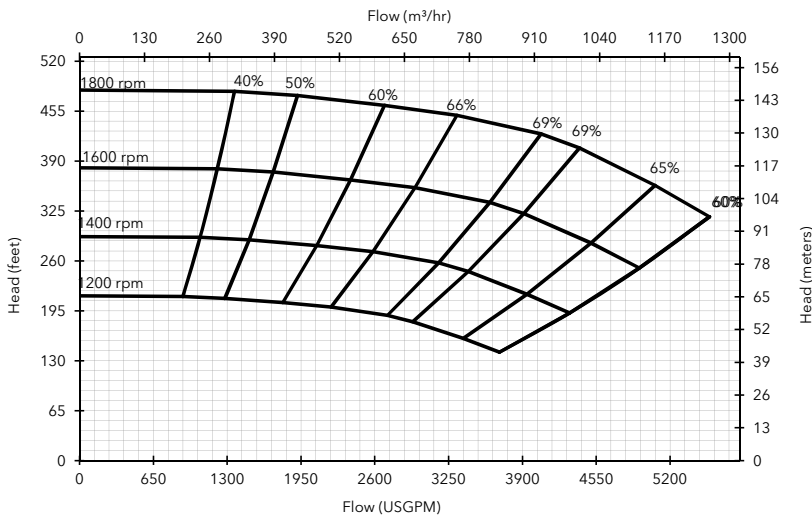

## Materials

Pump casing & suction cover	Cast steel BS3100 A5
Wearplates	Cast Iron Chrome 1.0/1.5% Nickle 2%
Pump Shaft	Carbon steel BS 970 - 1991 817M40T
Impeller	Cast Steel BS3100 A5 Hardness to 200 HB Brinell
Non-return valve body	Cast Iron
Mechanical seal	Double Mech seal; Tungsten carbide face; Viton elastomers; Stainless steel body

## Engine option 1

Caterpillar C18 (T3 Flex), 700 HP @ 1800 rpm

Impeller diameter 21.3"

Pump speed 1800 rpm

### Suction Lift Table

Total Suction Head (feet)	Total Delivery Head (feet)				
	361	394	427	443	459
	Output (USGPM)				
10	4733	4073	3302	2642	1321
15	4733	4073	3302	2642	1321
20	3742	3522	3082	2201	1321
25	2201	1761	1321	881	-

Fuel capacity: 375 US Gal

Max Fuel consumption @ 1800 rpm: 36.2 US Gal/hr

Max Fuel consumption @ 1600 rpm: 34.0 US Gal/hr

Weight (Dry): 14,850 lbs

Weight (Wet): 17,550 lbs

Dimensions: (L) 168" x (W) 79" x (H) 99"

Performance data provided in tables is based on water tests at sea level and 20°C ambient. All information is approximate and for general guidance only. Please contact the factory or office for further details.

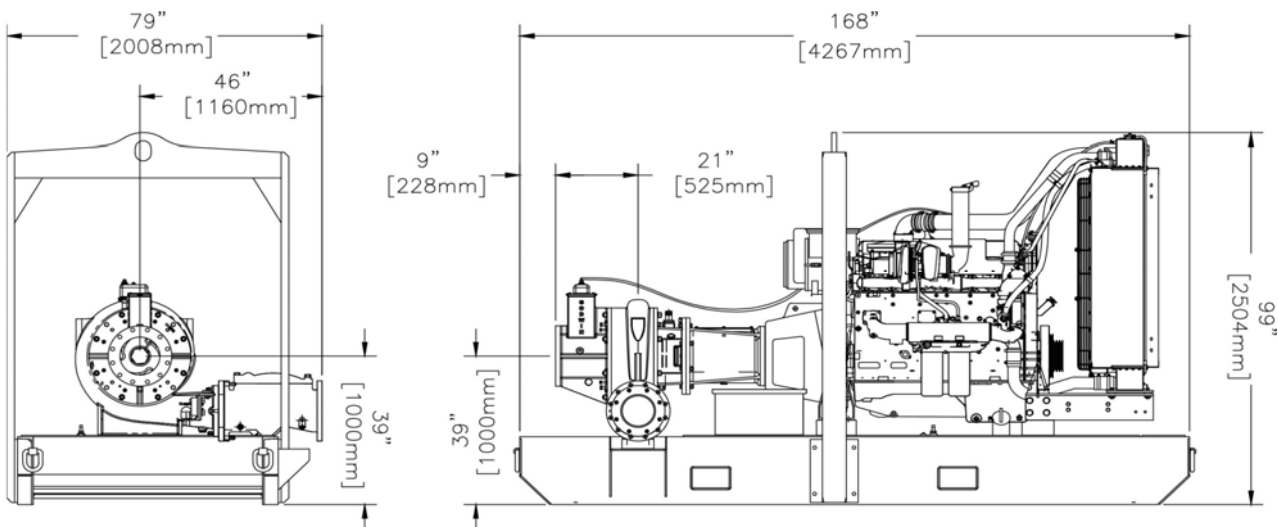

84 Floodgate Road  
 Bridgeport, NJ 08014 USA  
 (856) 467-3636 . Fax (856) 467-4841  
 Email: sales@godwinpumps.com

Reference number : 95-1119-3000  
 Date of issue : September 15, 2014  
 Issue : 4

[www.godwinpumps.com](http://www.godwinpumps.com)